

CFEWH SERIES 6-13

INSTALLATION OPTIONS

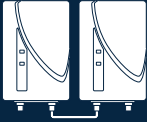

UNITS CAN BE INSTALLED IN TANDEM TO DOUBLE FLOW RATES, IF NEEDED.

YOUR NEEDS WILL DEPEND ON YOUR REGIONAL CLIMATE, REFER TO OUR FLOW TABLES FOR SPECIFICATIONS.

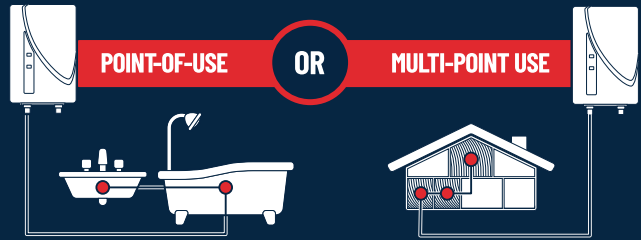

Here are some suggested options for installation. The flexibility of the unit allows custom solutions for your needs, whether point-of-use or multi-point use. *Please note that the location and installation of the unit is not limited to the options shown here.*

Units can be installed in tandem to double flow rates, if needed. Your needs will depend on your regional climate; refer to our flow tables for specifications.

NOTE: When the CFEWH is connected to a washing machine, dishwasher, etc. with automatic on/off controlled inlet valve and for long pipe runs, a water hammer arrestor must be mounted at the outlet of the CFEWH. This will reduce the water hammer effect during the automatic turning off of the water inlet valve of these appliances.

The CFEWH should be installed in a vertical position on an internal wall, or in an internal cupboard or space.

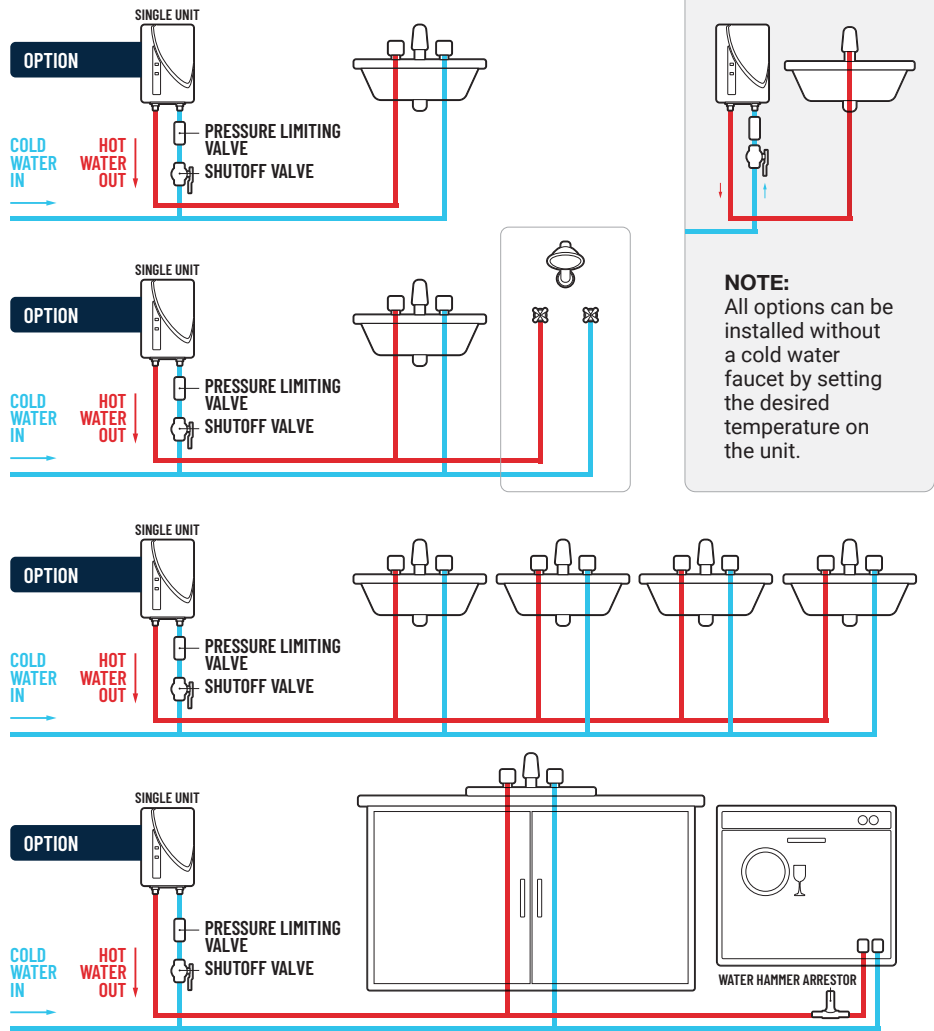

NOTE: All options can be installed without a cold water faucet by setting the desired temperature on the unit.

IMPORTANT: Where the ambient temperatures are likely to approach freezing, i.e., less than 41°F, the unit must be drained of water to prevent frozen water damage from occurring.

Failure to comply with the installation and operating instructions, or improper use, voids the warranty.

